

# VACUUM OIL FILTERS

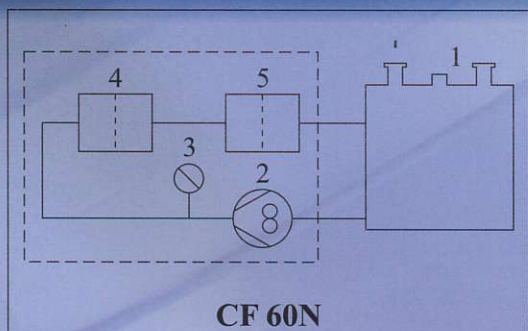

## CF 60N

*Vacuum pump  
Oil pump  
Manometer  
Chemical filter  
Mechanical filter*

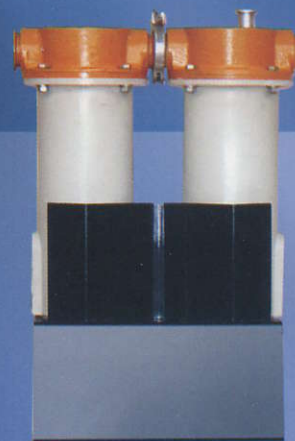
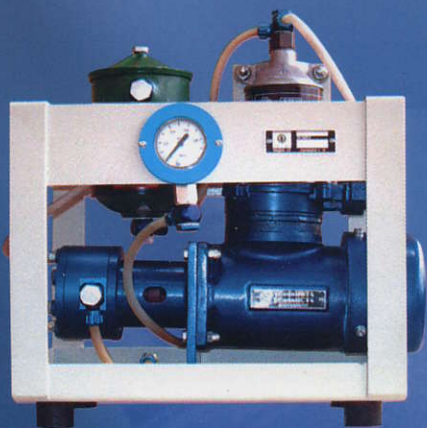
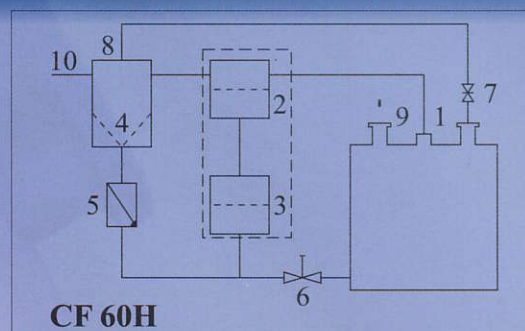

## CF 60H

*CF 60H  
Output nozzle  
Chemical filter  
Mechanical filter  
Discharge filter  
Retaining valve  
Closing valve*

*Retaining valve for  
excessive pressure  
Balancing pipeline  
Suction nozzle for  
vacuum pump  
System discharge  
nozzle*

## SPECIFICATIONS

Description	Measure	CF-60N	CF-60H
Oil capacity	l	1,5	1,5
Capacity of filtering substances (materials)	kg	0,450	0,450
Motor power	kW	0,25	---
Electrical supply	V	220V/50Hz 1-PH	---
Motor revolutions	min <sup>-1</sup>	1400	---
Discharge of oil-circulator	l/min	5,2	---
Max allowable pressure	bar	6	---
Dimension	mm	410(L)x240(W)x350(H)	500(L)x250(W)x500(H)
Weight	kg	21,5	10

## FEATURES & BENEFITS

- *Filtering oil in standard and chemical vacuum processes*
- *Canister with different filter element can be supplied*
- *Easy removal and replacement of filters*
- *Compact design and reliable operation*
- *Special elements for neutralization*
- *Removes particulates or acids in the oil*
- *Filter elements remove water from the oil*
- *Extended oil life*

## FILTER ELEMENTS

- *Fullers earth*
- *Activated alumina*
- *Activated carbon*
- *Hydrophilic filter*
- *Paper*



# OIL MIST ELIMINATORS TRAPS



## SPECIFICATIONS

Description	Measure	OF 40	OF C 25	OF C 40	IF 25	IF 40
Type		Outlet	Outlet	Outlet	Inlet	Inlet
Input/ Output type	mm	NW 40/NW 40	NW 25/NW 25	NW 40/NW 40	NW 25/NW 25	NW 40/NW 40
Dimensions	mm	180(L)x371(H)	130(L)x358(H)	174(L)x455(H)	90(L)x190(H)	110(L)x230(H)
Weight	kg	4	2,5	5,2	1,4	2,6

## APPLICATIONS

- Industrial vacuum processes
- Vacuum forming
- Vacuum freeze drying
- Vacuum furnaces
- Custom systems
- Vacuum coating
- Vacuum outgassing
- Food processing
- Vacuum drying

## BENEFITS

- Oil filtration
- Cooling by the oil circulation
- Heavy duty ability
- High oil catching efficiency - more than 99%
- A sight glass allows monitoring the quantity of oil retained
- Easy replacement
- Ensures environmental protection

## FEATURES

- Oil mist, exhaust and fumes eliminated at outlet on vacuum pumps
- Attached to the pump by standard NW 25/40 connections
- Usage of the outlet mist filter is recommended in accordance with health and safety regulations
- Oil return kits can be used optionally



# HIGH VACUUM VALVES

## Electropneumatic Actuation Valve - EPVV

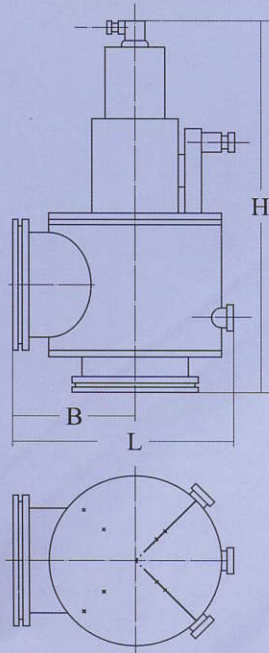

## Solenoid Actuation Valve - EMVV

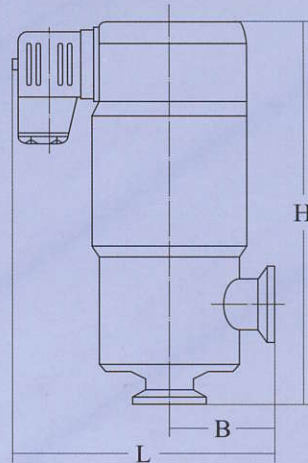

### FEATURES

- Electropneumatic or solenoid actuation
- Compact right-angle
- Stainless steel body
- Standard NW connection
- Reliable operation in the atm. to  $10^{-9}$  mbar vacuum range

### BENEFITS

- Fast acting
- Long life duties
- Economical design
- Low cost

### SPECIFICATIONS

Description		Measure	Model						
			EPVV 63	EPVV 160	EPVV 250	EPVV 400	EMVV 16	EMVV 25	EMVV 40
Conductance		l/s	150	1200	2700	7700	3,5	11	34
Leak rate		mbar x l/s	$1 \times 10^{-9}$	$1 \times 10^{-9}$	$1 \times 10^{-9}$	$1 \times 10^{-9}$	$1 \times 10^{-9}$	$1 \times 10^{-9}$	$1 \times 10^{-9}$
Max air pressure		bar	6,3	6,3	6,3	6,3	---	---	---
Full power	Max	W	---	---	---	---	720	770	860
	Open position	W	---	---	---	---	20	20	40
Electrical supply		V/Hz	220/50	220/50	220/50	220/50	220/50	220/50	220/50
Reliability (MTTF)		cycles	100 000	100 000	50 000	50 000	100 000	100 000	100 000
Max. frequency		cycles/h	240	240	240	120	360	360	360
Regime of work			R1	R1	R1	R1	R1	R1	R1
Fuse rating		V/A	220/0,5	220/0,5	220/0,5	220/0,5	---	---	---
NW Diameter		mm	63	160	250	400	16	25	40
Angle module (B)		mm	90	150	220	300	40	50	65
Position of work			ARBITRARY						
Dimensions	L	mm	270	296	460	686	95	110	135
	H	mm	400	552	820	1001	159	188	222
Weight		kg	16	30	79	180	1,6	2,45	5

